

AC CONTACTOR MAGNETIC STRARTRR

veKON

WE *are*
VEKON
GLOBAL

About us

VEKON Global company is a leading provider of high-technology products and complex solutions in the fields of electrical engineering, automation, and engineering infrastructure.

We promote the VEKON brand and its values worldwide, ensuring easy access for our Customers to VEKON innovations through a wide product range, balanced commercial policies, and exceptional Customer service.

Our core manufacturing facility, Zhejiang VEKON Technology Co., Ltd., located in Yueqing Bay Power Technology Town, Zhejiang Province, China, is a technological leader in modular electrical equipment. Established in 2002, it produces a diverse range of products including RCCB/RCBOs, MCBs, AFDDs, relays, contactors, and signaling and control devices. Manufactured on automated production lines, the facility boasts a daily output of 500,000 units. Our products are exported globally to Europe, the Americas, Southeast Asia, and Africa. Advanced technology, reliable equipment, guaranteed quality, and dedicated technical support have secured a substantial base of loyal customers worldwide. VEKON holds patents on its own designs and its products are CE, SEMKO, KEMA, and other internationally recognized certifications

compliant. Our manufacturing facilities maintain ISO 9001 certification.

In addition to Zhejiang VEKON Technology Co., Ltd., the VEKON brand encompasses over 30 other manufacturing sites across Mainland China. We design, manufacture, and supply a comprehensive range of low – and medium-voltage electrical products (up to 35 kV), as well as a wide array of industrial automation and process control equipment.

VEKON's strategy is built on Partnerships. By collaborating with professional distributors, retailers, panel builders, installers, system integrators, and service centers, we strive to provide seamless customer proximity. At VEKON, responsibility and reputation are paramount. Our greatest reward is the establishment of long-term, mutually beneficial business and personal relationships with our Partners.

Customers and Partners who choose VEKON products can rely on our commitment to VEKON values throughout the entire product lifecycle – from ideation and innovation to manufacturing, reliable supply, comprehensive solution implementation, and comprehensive warranty and post-warranty services.

LC1-N

Series AC CONTACTOR 交流接触器系列

适用范围 Application

LC1-N 系列交流接触器用于交流50/60HZ, 额定绝缘电压为1000V的电路中, 在AC-3使用类别下额定工作电流为9~95A, 主要供远距离接通与分断电路及频繁起动, 停止及控制交流电动机, 并且可以和热继电器直接插接安装组成电磁起动器。产品符合IEC60947-4标准。

LC1-N SERIES AC contactors are suitable for frequency 50/60HZ, rated insulation voltage up to 1000V, rated operation current 9-150A under AC-3 duty. It is mainly used for making and breaking electric circuits at a long distance & for frequent starting, stopping & controlling AC Motors. it is used in combinatio with thermal relay to compose a magnetic motor starter, The products comply with IEC60947-4



LC1-09-18N



LC1-25-32N



LC1-40-65N

技术参数 Specifications

额定电流 Rated current						
le max AC-3(Ue≤440V)	9A	12A	18A	25A	32A	
le AC-1(0≤60°C)	25A	32A		40A	50A	
极数 Number of poles	3	3	4	3	3	4
额定动作功率 Rated operational power in AC-3	220/240V	2.2KW	3KW	4KW	5.5KW	7.5KW
	380/400V	4KW	5.5KW	7.5KW	11KW	15KW
	415/440V	4KW	5.5KW	9KW	11KW	15KW
	500V	5.5KW	7.5KW	10KW	15KW	18.5KW
	660V/690V	5.5KW	7.5KW	10KW	15KW	18.5KW
	1000V					
辅助触头 Auxiliary contacts	范围组成达4N/C或N/O瞬时, 达1N/C+N/O延时以及2N/O或N/C保护触头及2屏连续性终端。 range comprising up to 4 N/C or N/O in st ant aneous, up to 1 N/O+1N/C time delay and up to 2N/O or N/C protected contacts and 2 screen continuity terminals					
兼容手动或自动 热过载继电器 Compatible manual or auto th ermal overload relays	Class 10A	0.10...10A	0.10...13A	0.10...18A	0.10...32A	0.10...38A
	Class 20	2.5...10A	2.5...13A	2.5...18A	2.5...32A	
抑制器模块(标准的直流 低耗接触器具备内置抑 制限制二极管) Suppressor modules d.c.and low consum ption contactor hve built in suppression limiting diode as standard	Varistor					
	Diode					
	RC circuit					
	Bidirectional peak					
界面 Inter faces	继电器 Relay					
	继电器+超驰功能 Relay+override function					
	固态 Solid state					
接触器参考型号 Contactor type references	~or==3P	LC1-09N	LC1-12N	LC1-18N	LC1-25N	LC1-32N
	~4P	LC1-12N		LC1-25N		
	==4P	LC1-12N		LC1-25N		
反转接触器 参考型号 Reversing Contactor type references	~3P	LC1-09N	LC1-12N	LC1-18N	LC1-25N	LC1-32N
	==3P	LC1-09N	LC1-12N	LC1-18N	LC1-25N	LC1-32N
	~4P	LC1-12N		LC1-25N		
	==4P	LC1-12N		LC1-25N		

LC1-N
Series AC CONTACTOR
交流接触器系列

标准控制断路电压 Standard control circuit voltages

Volts	24	42	48	110	220	230	240	380	400	415	440	500	660
50Hz	B5	D5	E5	F5	M5	P5	U5	Q5	V5	N5	R5	S5	Y5
60Hz	B6	D6	E6	F6	M6	-6	U6	Q6	-	-	R6	-	-
50/60Hz	B7	D7	E7	F7	M7	P7	U7	Q7	V7	N7	R7	-	-



LC1-80-95N

38A	40A	50A	65A	80A	95A	115A	150A
	60A	80A		125A		200A	
	3 4	3	3 4	3 4	3	3 4	3
9KW	11KW	15KW	18.5KW	22KW	25KW	30KW	40KW
18.5KW	18.5KW	22KW	30KW	37KW	45KW	55KW	75KW
18.5KW	22KW	25/30KW	37KW	45KW	45KW	59KW	80KW
18.5KW	22KW	30KW	37KW	55KW	55KW	75KW	90KW
18.5KW	30KW	33KW	37KW	45KW	45KW	80KW	100KW
	22KW	30KW	37KW	45KW	45KW	75KW	90KW



LC1-115N

范围组成达4N/C或N/O瞬时, 达1N/C+N/O延时以及2N/O或N/C保护触头及2屏连续性终端
range comprising up to 4 N/C or N/O instantaneous, up to 1N/O+1N/C time delay and up to 2 N/O or N/C protected contacts and 2 screen continuity terminals

0.10...38A	17...50A	17...70A	17...80A	17...104A	17...104A	60...150A	60...150A
	17...40A	17...65A	17...70A	17...80A		60...150A	60...150A

LC1-38N	LC1-40N	LC1-50N	LC1-65N	LC1-80N	LC1-95N	LC1-115N	LC1-150N
	LC1-40N		LC1-65N	LC1-80N		LC1-115N	
	LC1-40N		LC1-65N	LC1-80N		LC1-115N	
LC1-38N	LC1-40N	LC1-50N	LC1-65N	LC1-80N	LC1-95N	LC1-115N	LC1-150N
LC1-38N							
	LC1-40N		LC1-65N	LC1-80N		LC1-115N	



LC1-150N

AM-CJX

Series AC CONTACTOR 交流接触器系列

适用范围 Application

AM-CJX 列交流接触器以下简称接触器适用于交流50/60Hz,电压660V, 电流95A的电路中, 供远距离接通与分断电路及频敏起动、控制交流电动机, 接触器还可组装成积木式辅助触头组, 空气延时头, 机械连锁机构等部件, 组成延时接触器可逆接触器, 星三角起动机, 并且可以和热继电器直接插接安装组成电磁起动机。

AM-cjx series AC contactor is suitable for using in the circuits up to the rated voltage 660V AC 50/60Hz, rated current up to 660V/95A, for making, breaking, frequently starting & controlling the AC motor, combined with the auxiliary contact block, timer delay & machine-interlocking device etc it becomes the delay contactor mechanical interlocking contactor, star-delta starter with the thermal relay it is combined into the electromagnetic starter the products comply with IEC60947-4

AM-CJX-D09-12



技术参数 Specifications

型号Model	D09	D12	D18	D25	D32	D40	D50	D65	
额定工作电流 rated working current(A)	AC3	9	12	18	25	32	40	50	65
	AC4	3.5	5	7.7	8.5	12	18.5	24	28
三相鼠参型电动机 AC-3级	220/230V	2.2	3	4	5.5	7.5	11	15	18.5
	380/400V	4	5.5	7.5	11	15	18.5	25	30
Ac3 capacity squirrel-cage motor AC3(kw)	415V	4	5.5	9	11	15	22	25	37
	500V	5.5	7.5	10	15	18.5	22	30	37
	660/690V	5.5	7.5	10	15	18.5	30	33	37
额定发热电流rated heat current(A)	20	20	32	40	50	60	80	80	
电气寿命 electrical life	AC3X10 ⁺	100	100	100	100	80	80	60	60
	AC4X10 ⁺	20	20	20	20	20	15	15	15
机械寿命Mechanical lifeX10 ⁺	1000	1000	1000	1000	800	800	800	800	
触头型号number of the contacts	3P+NO			3P+NO			3P+NC+NO		

AM-CJX-D25



AM-CJX-D32



安装与外形尺寸图Dimension & mounting size

用于LC1-D09-95接触器 For AM-CJX-D09-95 factors

型号Model	A	B	C	D	E	a	b	φ
AM-CJX -D09-12	47	76	82	113	133	34/35	50/60	4.5
AM-CJX -D18	47	76	87	118	138	34/35	50/60	4.5
AM-CJX -D25	57	86	95	126	146	40	48	4.5
AM-CJX -D32	57	86	100	131	151	40	48	4.5
AM-CJX -D40-65	77	129	116	145	165	40	100/110	6.5
AM-CJX -D80-95	87	129	127	175	195	40	100/110	6.5

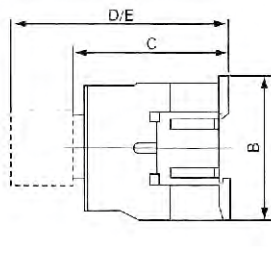

AM-CJX-D09-32

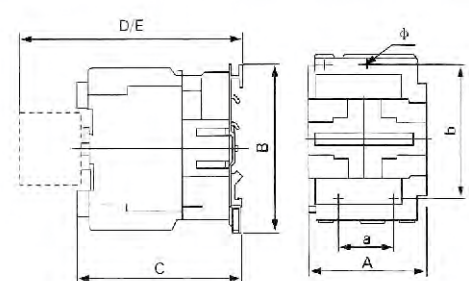

AM-CJX-D40-95



AM-CJX-D40-95

AC-A-D

**Series AC CONTACTOR
交流接触器系列**

标准控制回路电压Standard control circuit voltqages

电压Volts	24	42	48	110	220	230	240	380	400	415	440	500	660
50Hz	B5	D5	E5	F5	M5	P5	U5	Q5	V5	N5	R5	S5	Y5
60Hz	B6	D6	E6	F6	M6		U6	Q6			R6		
50/60Hz	B7	D7	E7	F7	M7	P7	U7	Q7	V7	N7	R7		

技术参数 Specifications

D80	D95	D115	D150	D170	D205	D245	D300	D410	D475	D620
80	95	115	150	170	205	245	300	410	475	620
37	44	52	60	75	85	105	117	138	147	180
22	25	30	40	55	63	75	100	110	147	200
37	45	55	75	90	110	132	160	220	265	335
45	45	59	80	100	110	132	180	220	280	375
55	55	75	90	110	129	160	200	250	355	400
45	55	80	100	110	129	160	220	280	355	450
125	125	200	250	250	275	315	400	500	700	1000
60	60	200	60	60	50	50	50	30	30	20
10	10	15	15	15	15	15	15	8	8	5
600	600	300	300	300	300	300	300	100	100	100

3P+NC+NO

安装与外形尺寸图Dimension & mounting size

用 AC-A-D115-620 接触器 For C AC-A -D115-620 contactors

型号 Type	A	B	C	B1	P	Q	S	Q1	M	N	L	φ	Ga	Ha
AC-A D115	158	120	132	158	35	60	17	25	134	96.2	75	M6		
AC-A D150	158	120	132	158	35	60	17	25	134	96.2	75	M6		
AC-A D170	158	120	132	158	35	60	17	25	134	96.2	75	M6		
AC-A D205	168.5	174	181	137	40	69	20	59.4	154	127	113.5	M8	80	120-106
AC-A D245	168.5	197	181	137	48	69	25	51.5	172	127	113.5	M10	80	120-106
AC-A D300	213	206	219	145	48	91	25	74	181	158	145	M10	80	120-106
AC-A D410	213	206	219	209	48	91	25	74	181	158	145	M10	80	120-106
AC-A D475	233	238	232	209	55	108	30	77	208	172	146	M10	80	180
AC-A D620	309	304	255	280	80	140	40	89	264	202	155	M12	80	180

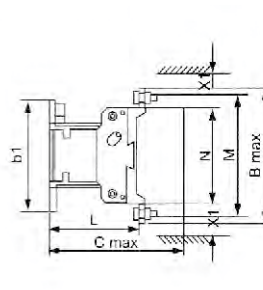
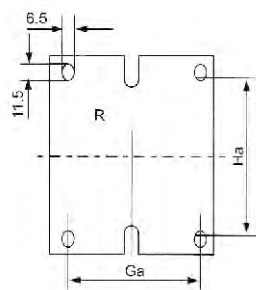
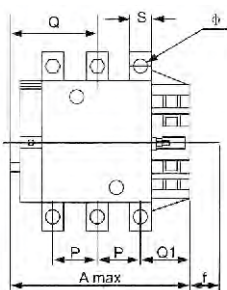

AC-A-D115



AC-A-D205



AC-A-D245



AC-A-D410

AC-A-F Series AC CONTACTOR 交流接触器系列

适用范围 Application

AC-A-F系列交流接触器适用于交流50/60Hz,额定电压至1000V, 额定电流115-800A的电路中, 作远距离分断电流及频繁起动或控制电动机之用,它也用于控制额定电流200~1600A的配电路路中. AC-A-F series AC contactor is applicable to the circuits up to the rated voltage 1000VAC 50 Hz or 60Hz rated current from 115/800A for longdistance breaking circuit and frequently starting or controlling the motor it also can be used for the control of distribution circuits of rated current from 200/1600A



AC-A-F330



AC-A-F400



AC-A-F630

技术参数 Specifications

型号 type	AC-A-F115	AC-A-F150	AC-A-F185	AC-A-F225	AC-A-F265	AC-A-F330
额定工作电流 rated working current (A)	AC3	115	150	185	225	330
	AC1	200	250	275	315	400
三相电动机标准 额定功率 Standard power ratings of 3-phase motors AC3(kw)	220/230V	30	40	55	63	75
	380/400V	55	75	90	110	132
	415V	59	80	100	110	140
	440V	59	80	100	110	140
	500V	75	90	110	129	160
660/690V	80	100	110	129	160	200
1000V	65	65	100	100	147	160

型号 type	AC-A -F400	AC-A -F500	AC-A -F630	AC-A -F780	AC-A -F800	
额定工作电流 rated working current (A)	Ac3	400	500	630	780	800
	AC1	500	700	1000	1500	1500
三相电动机标准 额定功率 Standard power ratings of 3-phase motors AC3(kw)	220/230V	110	147	200	220	220
	380/400V	200	250	335	400	400
	415V	200	280	375	425	420
	440V	250	295	400	425	420
	500V	257	355	400	450	430
660/690V	280	335	450	475	470	
1000V	185	335	450	450	450	

3极和4极都有用
Both 3pole and 4pole are available



AC-A-F7804

CJX2-N
Mechanical Interlocking Contactor
机械联锁接触器系列

1. Application

CJX2-N mechanical interlocking contactor is suitable for using in the circuits up to the rated voltage 660V AC 50/60Hz, current 620A, for convertible controlling the motor. This mechanical interlocking device ensures contact changeover of the two convertible contactors. It conforms to IEC60947-4-1.

2. Specification

Type	Rated current AC-3(A)	Controlled power (kW)				
		220V	380V	415V	440V	660V
CJX2-09N	9	2.2	4	4	4	5.5
CJX2-12N	12	5.5	5.5	5.5	5.5	7.5
CJX2-18N	18	7.5	7.5	9	9	10
CJX2-25N	25	5.5	11	11	11	15
CJX2-32N	32	7.5	15	15	15	18.5
CJX2-40N	40	18.5	18.5	22	22	30
CJX2-50N	50	15	22	25	30	33
CJX2-65N	63	18.5	30	37	37	37
CJX2-80N	80	22	37	45	45	45
CJX2-95N	95	22	45	45	45	41
CJX2-115N	115	30	55	59	59	80
CJX2-150N	150	40	75	80	80	100
CJX2-170N	170	55	90	100	100	110
CJX2-205N	205	63	110	110	110	129
CJX2-245N	245	75	132	132	132	160
CJX2-300N	300	100	160	200	200	220
CJX2-410N	410	110	220	250	250	280
CJX2-475N	475	147	265	280	280	355
CJX2-620N	620	200	335	400	400	450



CJX2-09~12N



CJX2-12~18N



CJX2-40~95N



AC-A2-F

Type	Number of poles	Rated current AC-3(A)	Rated current In/A	Controlled power(kW)	
				220V	380V
AC-A2-F115N	3P	115	250	200	55
AC-A2-F1154N	4P	115	250	200	55
AC-A2-F150N	3P	150	355	250	75
AC-A2-F1504N	4P	150	355	250	75
AC-A2-F185N	3P	185	425	275	90
AC-A2-F1854N	4P	185	425	275	90
AC-A2-F225N	3P	225	500	315	110
AC-A2-F2254N	4P	225	500	315	110
AC-A2-F265N	3P	265	630	350	132
AC-A2-F2654N	4P	265	630	350	132
AC-A2-F330N	3P	330	800	400	160
AC-A2-F3304N	4P	330	800	400	160
AC-A2-F400	3P	400	800	500	200
AC-A2-F4004N	4P	400	800	500	200
AC-A2-F500N	3P	500	1000	700	250
AC-A2-F5004N	4P	500	1000	700	250
AC-A2-F630N	3P	630	1250	1000	335
AC-A2-F6304	4P	630	1250	1000	335
AC-A2-F800N	3P	800	1250	1000	400

AM-CJX-P DC contactor 直流接触器系列

1. Application

A M - C J X -P series perated contactor is suitable for use in the circuits up to rated voltage 660V AC 50Hz or 60Hz, and in rated current 9–95A inAC–3/380V load circuits. For remote controlling circuit making, breaking and frequent startingACmotors. It can also combine with the auxiliary contact group, air delayer, thermal relay devices etc.



AM-CJX-P9-32

2. Specification

Type			AM-CJX-P9	AM-CJX-P12	AM-CJX-P18	AM-CJX-P25	AM-CJX-P32
Rated working current(A)	380V	AC3	9	12	18	25	32
		AC4	3.5	5	7.7	8.5	12
	660V	AC3	6.6	8.9	12	18	21
		AC4	1.5	2	3.8	4.4	7.5
Rated heat current(A)			25	25	32	40	50
Controllable power(kW)	220/240V		2.2	3	4	5.5	7.5
	380/400V		4	5.5	7.5	11	15
	415V		4	5.5	9	11	15
	500V		5.5	7.5	10	15	18.5
	600/690V		5.5	7.5	10	15	18.5
Weight(Kg)	DC contactor		0.64	0.34	0.65	0.65	0.95
Measure(Mm ³)	DC contactor		76x115x47	76x115x47	76x120x47	88x130x59	86x135x59
Pole			3, 4	3, 4	3	3, 4	3
Rated working voltage(V)			380, 660	380, 660	380, 660	380, 660	380, 660
Rated insulation voltage(V)			660	660	660	660	660
Mechanical life x10 ⁴			1000	1000	1000	1000	800
Electrical life	AC x10 ⁴		100	100	100	100	80
	AC4 x10 ⁴		20	20	20	20	20
Operating frequency	Electrical life	AC3 x10 ⁴	1200	1200	1200	1200	600
		AC4 x10 ⁴	300	300	300	300	300
	Mechanical life x10 ⁴		3600	3600	3600	3600	3600
Rated controlled voltage(V)			24–660	24–660	24–660	24–660	24–660
Working voltage	Close	DC %	0.85~1.1Us	0.85~1.1Us	0.85~1.1Us	0.85~1.1Us	0.85~1.1Us
	Open	DC %	0.10~0.75Us	0.10~0.75Us	0.10~0.75Us	0.10~0.75Us	0.10~0.75Us



AM-CJX-P40-95

Type			AM-CJX-P40	AM-CJX-P50	AM-CJX-P65	AM-CJX-P80	AM-CJX-P95
Rated working current(A)	380V	AC3	40	50	65	80	95
		AC4	18.5	24	28	37	44
	660V	AC3	34	39	42	49	55
		AC4	9	12	14	17.3	21.3
Rated heat current(A)			60	80	80	125	125
Controllable power(kW)	220/240V		11	15	18.5	22	25
	380/400V		18.5	22	30	37	45
	415V		22	30	37	45	45
	500V		22	30	37	55	55
	600/690V		30	33	37	45	55
Weight(Kg)	DC contactor		2.185	2.185	2.185	2.525	2.525
Measure(Mm ³)	DC contactor		128x175x81	128x175x87	128x175x87	128x183x87	128x183x8
Pole			3, 4	3, 4	3, 4	3, 4	3, 4
Rated working voltage(V)			380, 660	380, 660	380, 660	380, 660	380, 660
Rated insulation voltage(V)			660	660	660	660	660
Mechanical life x10 ⁴			800	800	800	600	600
Electrical life	AC x10 ⁴		80	80	80	60	60
	AC4 x10 ⁴		15	15	15	10	10
Operating frequency	Electrical life	AC3 x10 ⁴	600	600	600	600	600
		AC4 x10 ⁴	300	300	300	300	300
	Mechanical life x10 ⁴		3600	3600	3600	3600	3600
Rated controlled voltage(V)			24–660	24–660	24–660	24–660	24–660
Working voltage	Close	DC %	0.85~1.1Us	0.85~1.1Us	0.85~1.1Us	0.85~1.1Us	0.85~1.1Us
	Open	DC %	0.10~0.75Us	0.10~0.75Us	0.10~0.75Us	0.10~0.75Us	0.10~0.75Us

AM-CJX-K
Series AC CONTACTOR
交流接触器系列

适用范围 Application

AM-CJX-K系列交流接触器适用于频动与控制交流电动机的电路中。辅助触头组可与热继电器组装起来能保护电路过载。

AM-CJX series AC contactor is suitable for use in the circuit for frequent starting controlling the AC motor the addition of auxiliary contact group to the contactor combined with the proper thermal relay can act to protect the circuit bound to overload.

技术参数 Specifications

型号 type		AM-CJX-K6	AM-CJX-K9	AM-CJX-K12
Ac3额定电流 Rated current at AC3(A)		6	9	12
额定工作电流 Rated working current (Ie)A		5	7.5	10
约定发热电流 Conventional thermal current(Ith)A		16	20	20
AC-3组控制功率 AC-3 Use Group Control Power KW	220V	1.5	2.2	3
	380/450V	2.2	4	5
	440/500V	3	4	5
	660V	3	4	5
额定工作电压 Rated working voltage(Ue)V		380 660		
额定绝缘电压 Rated insulation voltage(Ue)V		690		
AC-3(6Ie Ie)	电气寿命 Electrical life (time)	0.5X10 ⁶		
	操作频率 Oper ation frequency	1200		
AC-4(6Ie Ie)	电气寿命 Electrical life (time)	10X10 ⁴		
	操作频率 Oper ation frequency	300		
机械寿命 Mechanical life		3X10 ⁶		
辅助触头 Auxiliary contact	约定发热电流 Conventional thermal current	6A		
	机械寿命 Electrical life	AC-15(360VA)	0.5X10 ⁶	
	次 times	DC-13(33W)		



AM-CJX-K6-K9-K12

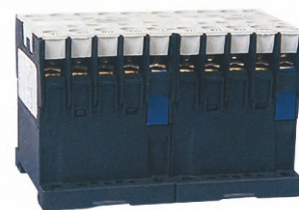

AM-CJX2-K6-K9-K12

3TF

Series AC contactor 交流接触器系列

适用范围 Application

3TF系列交流接触器适用于交流频率50/60Hz, 额定工作电压至660V的电路中, 供远距离接通和分断电路及频繁起动和控制交流电动机,并可与适当的热过载继电器组成电磁起动器,用于保护可能发生的过负荷电路

3TB系列交流接触器为双断点直动式结构,触头支持与街铁间采用弹性卡扣联接,保证良好的吸合特性,所有导电部件均有绝缘防护罩,具有较高的防护性能,全系列产品均可用螺钉安装,32A及以下规格还可采用卡轨安装。

产品符合IEC60947-4

3TF series AC contactors are suitable in electrical system with AC 50/60Hz, rated operational voltage up to 660V In AC-3 usage rated operational voltage up to 380V rated operational current up to 630A to make or break remote motors or system they can form electromagnetic starters with suitable thermal overload relays 3UA series to protect system and motors against overload or phase failure they are made according to IEC60947-4

The contactor is a straight motion mechanism having double breaking contacts the auxiliary contacts are arranged 2NO. 2NC at most it is employed the flexible locking connection between the contact support and core there are no arc isolated panel in the 22A contactors in the 32A contactors there are moulded arc chute with arc isolated panel because all contacts are made of high non fusibility and against corrosion silver alloy all series products can be mounted by screws le 32A contactor also by installation rail.



AMUR-3TF-40



AMUR-3TF-50



AMUR-3TF-56

技术参数 Specifications

型号 type	额定发热电流 Rated thermal current(A)	额定工作电流 Rated operation current(A)		电动机控制功率 Controlled power of motor(KW)				辅助触头型号 Type of auxiliary contact
		380V	660V	380V	660V	380V	660V	
3TF30	20	9	3.33	4	5.5	1.4	2.4	NO NC 1NO+1NC 2NO+2NC
3TF31	20	12	4.33	5.5	7.5	1.9	3.3	
3TF32	30	18	7.77	7.5	11	3.5	6	
3TF33	30	22	8.5	11	11	4	6.6	
3TF34	45	32	15.6	15	23	7.5	13	
3TF35	45	38	18.5	18.5	23	9	15.5	
3TF40	20	9	3.3	4	5.5	1.4	2.4	
3TF41	20	12	4.3	5.5	7.5	1.9	3.3	
3TF42	30	16	7.7	7.5	11	3.5	6	
3TF43	30	22	8.5	11	11	4	6.6	
3TF44	45	32	15.6	15	23	7.5	13	2NC+2NO 4NC+4NO
3TF45	45	38	18.5	18.5	23	9	15.5	
3TF46	70	45	24	22	39	12	20.8	
3TF47	70	63	28	30	55	14	24.3	
3TF48	90	75	34	37	67	17	29.5	
3TF49	90	85	42	45	67	21	36	
3TF50	150	110	54	55	100	27	46.9	
3TF51	150	140	68	75	100	35	60	
3TF52	180	170	75	90	156	38	66	
3TF53	220	205	96	110	156	50	86	
3TF54	300	250	110	132	235	58	100	
3TF55	300	300	125	160	235	66	114	
3TF56	400	400	150	200	375	81	140	
3TF57	550	475	150	250	375	81	140	
3TF58	630	630	600	335	560	160	278	

3TB

**Series AC contactor
交流接触器系列**

适用范围 Application

3TB系列交流接触器适用于交流频率50/60Hz, 额定工作电压至660V,额定电流为630A的电路中, 用于接通分断及电动机的频繁起动和控制, 它可以和机械闭锁装置连用, 变成3TD系列可转换接触器, 用于控制, 起动, 断开及反转电机, 此产品符合IEC60947, VDE0660标准。

The contactor is suitable for using in the circuits up to the rated voltage 660V AC 50/60Hz, rated current 630A, for making and breaking and for frequent starting and controlling the motor After combined with the mechanical interlocking device it becomes 3TD series convertible contactor for controlling starting, breaking and reversing of the motor The products comply with IEC60947

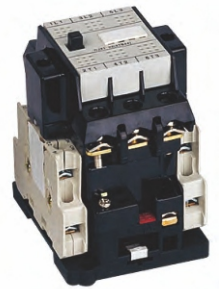

AMUR-3TB-44

技术参数 Specifications

型号 type	额定发热电流 Rated thermal current(A)	额定工作电流 Rated operation current at		电动机控制功率 Controlled power Of motor(KW)		辅助触头型号 Type of auxiliary contact
		AC 3 380V(A)	660V(A)	380V	660V	
3TB40	20	9	3.3	4	5.5	1NO
3TB41	20	12	4.3	5.5	7.5	1NC
3TB42	30	16	7.7	7.5	11	1NO+1NC
3TB43	30	22	8.5	11	11	2NP+2NC
3TB44	45	32	12	15	23	2NC+2NO

型号 type		辅助触头型号Type of contact	
		NO	NC
3TH80	40-40A	4	-
	31-0A	3	1
	22-0A	2	2
	13-0A	1	3
	04-0A	-	4
3TH82	80-0A	8	-
	71-0A	7	1
	62-0A	6	2
	53-0A	5	3
	44-0A	4	4



AMUR-3TH-80-82

AUXILIARY CONTACTOR 接触器辅助系列

5. Auxiliary Contact Block



AM-CJX-DN11

Appellation	Type	
Auxiliary instantaneous contactor block, contactor I	AM-CJX-DN10	
	AM-CJX-DN1	



AM-CJX-DN22

Appellation	Type	
Auxiliary instantaneous contactor block, contactor II	AM-CJX-DN11	
	AM-CJX-DN20	
	AM-CJX-DN2	

Appellation	Type	
Auxiliary instantaneous contactor block, contactor IV	AM-CJX-DN40	
	AM-CJX-DN31	
	AM-CJX-DN22	
	AM-CJX-DN13	
	AM-CJX-DN4	



AM8-CJX-DN11

Appellation	Type	
Auxiliary instantaneous contactor block, contactor IV	AM-CJX-DN40	
	AM-CJX-DN31	
	AM-CJX-DN22	
	AM-CJX-DN13	
	AM-CJX-DN4	

Appellation	Type	
Side-mounted auxiliary module	AM8-CJX-DN11	
	AM8-CJX-DN20	

6. LA2 Time Delay Auxiliary Contact Block



AM2-CJX-DT2

Appellation	Type	
Auxiliary instantaneous contactor block, contactor IV	0.1...3S AM2-CJX-DT0	
	0.1...30S AM2-CJX-DT2	
	10...180S AM2-CJX-DT4	
	1...30S AM2-CJX-DS2	

Appellation	Type	
Time delay auxiliary contactor block releasing and delay	0.1...3S AM3-CJX-DT0	
	0.1...30S AM3-CJX-DT2	
	10...180S AM3-CJX-DT4	

GMC
Series ac contactor
交流接触器系列

适用范围 Application

GMC交流接触器适用于交流50/60Hz, 电压660V, 电流95A的电路中, 供远距离接通与分断电路及频繁启动, 控制交流电动机之用, 接触器还可组装成积木辅助触头组, 空气延时头, 机械联锁机构等附件, 组成延时接触器, 可逆接触器, 星三角启动器, 并且可以和热继电器直接插接安装。组成电磁启动器, 产品符合IEC 60947标准。

GMC series AC contactor is suitable for using in the circuits up to the rated voltage 660VAC 50/60Hz, rated current up to 95A, for making breaking frequently starting controlling the AC motor combined with the auxiliary contact block delay time machine interlocking device etc, it becomes the delay contactor mechanical interlocking contactor star delta starter with the thermal overload relay it is combined into the electromagnetic starter the contactor is produced according to IEC60947-4



AMUR-GMC-12



AMUR-GMC-32



AMUR-GMC-50



AMUR-GMC-125

技术参数 Specifications

型号 type	Ac1 使用类别 Ac1 duty		Ac3 使用类别 Ac3 duty				寿命 Life time (X10 ⁴)		辅助触头 Aux.contact
	200~240V	380~440V	500~550V	690V	电气 Electrical	机械 Mechanical			
GMC-9	20A 2.5KW	11A 5KW	9A 4KW	7A 4KW	5A 4KW	250	2500	1NO 1NC	
GMC-12	20A 3.5KW	13A 5KW	12A 7.5KW	12A 7.5KW	9A 7.5KW	250	2500		
GMC-18	25A 4.5KW	18A 7.5KW	18A 7.5KW	13A 7.5KW	9A 7.5KW	250	2500		
GMC-22	32A 5.5KW	22A 11KW	22A 15KW	22A 15KW	18A 15KW	250	2500	2NO 2NC	
GMC-32	50A 7.5KW	32A 15KW	32A 18.5KW	28A 18.5KW	21A 18.5KW	200	1500		
GMC-40	60A 11KW	40A 18.5KW	40A 22KW	32A 22KW	25A 22KW	200	1500		
GMC-50	80A 15KW	55A 22KW	50A 30KW	43A 30KW	33A 30KW	200	1000	2NO 2NC	
GMC-65	100A 18KW	65A 30KW	65A 37KW	60A 37KW	47A 37KW	200	1000		
GMC-75	110A 22KW	75A 37KW	75A 45KW	64A 45KW	47A 45KW	200	1000		
GMC-85	135A 25KW	85A 45KW	85A 45KW	75A 45KW	52A 45KW	200	1000		

辅助交流接触器Auxiliary for ac Contactor gmc



AU-2



AU-4

GMC-A Series ac contactor 交流接触器系列

适用范围 Application

CEMC交流接触器适用于交流50/60Hz, 电压660V, 电流95A的电路中, 供远距离接通与分断电路及频繁起动, 控制交流电动机之用, 接触器械还可组装成积木辅助触头组, 空气延时头, 机械联锁机构等附件, 组成延时接触器, 可逆接触器, 星三角起动器, 并且可以和热继电器直接插接安装。组成电磁起动器, 产品符合IEC 60947标准。

CEMC series AC contactor is suitable for using in the circuits up to the rated voltage 660VAC 50/60Hz, rated current up to 95A, for making breaking frequently starting controlling the AC motor combined with the auxiliary contact block delay time machine interlocking device etc, it becomes the delay contactor mechanical interlocking contactor star delta starter with the thermal overload relay it is combined into the electromagnetic starter the contactor is produced according to IEC60947-4

技术参数 Specifications

型号 type	Ac1 使用类别 Ac1 duty	Ac3 使用类别 Ac3 duty				寿命 Life time (X10 ⁴)		辅助触头 Aux.contact
		200~240V	380~440V	500~550V	690V	电气 Electrical	机械 Mechanical	
GMC-A-9	20A	2.5KW 11A	5KW 9A	4KW 7A	4KW 5A	250	2500	1NO 1NC
GMC-A-12	20A	3.5KW 13A	5KW 12A	7.5KW 12A	7.5KW 9A	250	2500	
GMC-A-18	25A	4.5KW 18A	7.5KW 18A	7.5KW 13A	7.5KW 9A	250	2500	
GMC-A-22	32A	5.5KW 22A	11KW 22A	15KW 22A	15KW 18A	250	2500	
GMC-A-32	50A	7.5KW 32A	15KW 32A	18.5KW 28A	18.5KW 21A	200	1500	
GMC-A-40	60A	11KW 40A	18.5KW 40A	22KW 32A	22KW 25A	200	1500	2NO 2NC
GMC-A-50	80A	15KW 55A	22KW 50A	30KW 43A	30KW 33A	200	1000	
GMC-A-65	100A	18KW 65A	30KW 65A	37KW 60A	37KW 47A	200	1000	
GMC-A-75	110A	22KW 75A	37KW 75A	45KW 64A	45KW 47A	200	1000	
GMC-A-85	135A	25KW 85A	45KW 85A	45KW 75A	45KW 52A	200	1000	



GMC-A-09-22

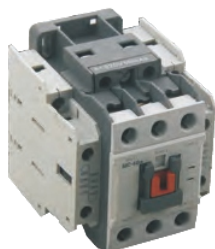

GMC-A-32-40



GMC-A-50-65



GMC-A-75-85

LR2-D

Thermal overload relay 热继电器系列

适用范围 Application

该系列热过载继电器适用于50/60Hz,额定绝缘电压660V, 额定电流为0.1~93A的电路中, 用于电机过载时的断相保护。

此继电器有不同的机构及温度补偿, 可插入LC1-D系列, AC触头, 它是世界上90年代最先进的继电器。产品符合IEC60947-4标准。

This series of thermal overload relay can be used in the circuit of 50Hz or 60Hz, rated insulation voltage 660V rated current 0.1-93A for protecting the phase break when the electric motor is overload. the relay has different mechanism and temperature compensation can be plugged in LC1-D series AC contactor it is the most advanced thermal relay in the nineties in the world the products comply with IEC60947-4



AMUR-LR2-D13



AMUR-LR2-D23



AMUR-LR2-D33

特点 Specifications

a.主电路基本参数

- 1.额定绝缘电压660V
- 2.额定工作电流25、35、93A
- 3.密封调节器额定整电流
热元件额定电流调节范围

b.辅助电路

- 1.具有电气隔离的常开和常闭
- 2.额定绝缘电压550V
- 3.额定频率50/60Hz
- 4.使用类别,额定工作电压, 约定
发热电流和额定工作电流

a.Fundamental parameter of the main circuit

- 1.Rated insulation voltage 660V
- 2.Rated working current 25,36,93A separately
- 3.The regulator seal of rated setting current
- 4.Current of the Thermal component see list 1

b.Auxiliary Circuit

- 1.There is one pair of N/O and N/C contact with electric insulation
- 2.Rated insulation Voltage 500V
- 3.Rated frequency 50/60Hz
- 4.Use group rated working voltage conventional thermal current and rated current

技术参数 Specifications

型号 type	额定工作电流 Rated working current	热元件 Thermal component	
		额定电流 Rted current A	额定电流选择范围 Regular or scale of rated current A
LR2-D 13 25	LR2-D 1301	0.16	0.10-0.16
	1302	0.25	0.16-0.25
	1303	0.40	0.25-0.40
	1304	0.63	0.40-0.63
	1305	1.0	0.63-1.0
	1306	1.6	1.0-1.6
	1307	2.5	1.6-2.5
	1308	4.0	2.5-4.0
	1310	6.0	4.0-6.0
	1312	8.0	5.5-8.0
	1314	10.0	7.0-10.0
	1316	13.0	9.0-13.0
	1321	18.0	12.0-18.0
1322	25.0	17.0-25.0	
LR2-D 23 36	LR2-D 2353	32	23.0-32.0
	2355	36	28.0-36.0
	LR2-D 3353	32	23.0-32.0
	3355	40	30.0-40.0
	3357	50	37.0-50.0
LR2-D 33 93	3359	65	48.0-65.0
	3361	70	55.0-70.0
	3363	80	63.0-80.0
	3365	93	80.0-93.0

LR9-F

Thermal overload relay
热继电器系列

技术参数 Specifications

型号 type	数量 Number	设定范围 Setting range	用于接触 For contactor
LR9-F53	F5357	30-50	F115-F185
	F5363	48-80	F115-F185
	F5367	60-100	F115-F185
	F5369	90-150	F115-F185
	F5371	132-220	F225-F265
LR9-F73	F7375	200-330	F330-F500
	F7379	300-500	F330-F500
	F7981	380-630	F400-F630



AMUR-LR9-F53

安装与外形尺寸图 Dimension & mounting size

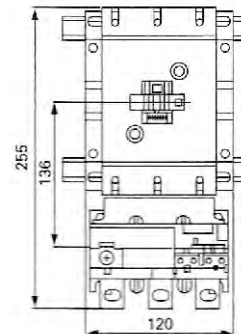
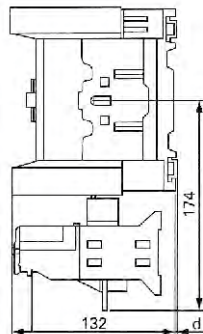

AMUR-LR9-F73

LR2-K

Thermal overload relay
热过载继电器

型号 type	电流调整范围 Current setting range	包装尺寸 Dimension	毛重KG G.W	净重KG N.W
LR2-K0301	0.1-0.16	36.5X25X34 100PCS	18	17
LR2-K0302	0.16-0.25			
LR2-K0303	0.25-0.3			
LR2-K0304	0.3-0.54			
LR2-K0305	0.54-0.8			
LR2-K0306	0.8-1.2			
LR2-K0307	1.2-1.8			
LR2-K0308	1.8-2.6			
LR2-K0310	2.6-3.7			
LR2-K0312	3.7-5.5			
LR2-K0314	5.5-8			
LR2-K0316	8-11.5			



AMUR-LR2-K

LRD

**Thermal overload realy
热继电器系列**

适用范围 Application



AMUR-LRD-13

该系列热继电器用于50/60Hz，额定绝缘电压660V，额定电流0.1~140A的电路中，作为电动机过载和断相保护之用。

此继电器有不同的机构及温度补偿，可插入LC1-D系列，AC触头，它是世界上90年代最先进的继电器产品符合IEC60947-4标准。

This series of thermal overload relay can be used in the circuit of 50Hz or 60Hz, rated insulation voltage 660V rated current 0.1-140A for protecting the phase break when the electric motor is overvoltage.

The relay has different mechanism and temperature compensation can be plugged in LC1-D series AC contactor it is the most advanced thermal relay in the nineties in the world the products comply with IEC60947-4

技术参数 Specifications



AMUR-LRD-33

型号 type	额定工作电流 Rated working Current	热元件 Thermal component		
		额定电流 Rated current(A)	额定电流选择范围 Regular or scale of rated current(A)	
LRD-13 25	LRD 1301	0.16	0.10-0.16	
		0.25	0.16-0.25	
		0.40	0.25-0.40	
		0.63	0.40-0.63	
		1.0	0.63-1.0	
		1.6	1.0-1.6	
		2.5	1.6-2.5	
		4.0	2.5-4.0	
		6.0	4.0-6.0	
		8.0	5.5-8.0	
		10.0	7.0-10.0	
		13.0	9.0-13.0	
		18.0	12.0-18.0	
		25.0	16.0-24.0	
LRD23 38	LRD 2332	32	23.0-32.0	
		38	30.0-38.0	
		LRD 3322	25	17.0-25.0
			32	23.0-32.0
			40	30.0-40.0
			50	37.0-50.0
			65	48.0-65.0
LRD33 140	LRD 3361	70	55.0-70.0	
		80	63.0-80.0	
		104	80.0-104.0	
		120	95.0-120.0	
		140	110.0-140.0	
		LRD 4365	104	80.0-104.0
			120	95.0-120.0
140	110.0-140.0			



AMUR-LRD-43

LR1-D Thermal overload relay 热继电器系列

适用范围 Application

LR1-D 系列热继电器适用于交流50/60Hz，电压660V电动机功率45KW及以下的电路中，供交流电动机热保护用。并且有差动机构和温度补偿环节，可与LC1-D交流接触器配套，也可独立安装，产品符合IEC60947-4标准。

LR1-D series thermal overload relay is suitable for thermal protection in the circuit with AC50/60Hz, voltage up to 660V motor power up to 45KW or less it has different attachment and temperature compensating function it can be fixed onto contactor and can also be fixed independently the product is made in accordance with IEC60947-4



AMUR-LR1-D09

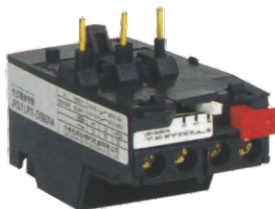

AMUR-LR1-D25



AMUR-LR1-D40-80

技术参数 Specifications

型号 type	电流调整范围 Adjusting range of current (A)	控制功率Control power (AC)(KW)					可插装的接触器 Plug-in contactor
		220V	380V	415V	440V	660V	
LR1-D 09301	0.1~0.16						LC1- D09-25
LR1-D 09302	0.16~0.25						LC1- D09-25
LR1-D 09303	0.25~0.40						LC1- D09-25
LR1-D 09304	0.40~0.63					0.37	LC1- D09-25
LR1-D 09305	0.63~1					0.55	LC1- D09-25
LR1-D 09306	1~1.6		0.37		0.55	0.7~1.1	LC1- D09-25
LR1-D 09307	1.6~2.5	0.37	0.55~0.75	1.1	0.55~0.75	1.5	LC1- D09-25
LR1-D 09308	2.5~4	0.55~0.75	1.1~1.5	1.5	1.5	2.2~3	LC1- D09-25
LR1-D 093010	4~6	1.1	2.2	2.2	2.2	4	LC1- D09-25
LR1-D 093012	5.5~8	1.5	3	3	3	5.5	LC1- D09-25
LR1-D 093014	7~10	2.2	4	4	4	7.5	LC1- D09-25
LR1-D 093016	10~13	3	5.5	5.5	5.5	10	LC1- D09-25
LR1-D 16321	13~18	3	7.5	9	9	15	LC1- D09-25
LR1-D 25322	18~25	5.5	11	11	11	18.5	LC1- D09-25
LR1-D 40353	23~32	7.5	15	15	15	22	LC1- D40 50 65
LR1-D 40355	30~40	10	18.5	22	2	30	LC1- D40 50 65
LR1-D 63357	38~50	11	22	25	25	37	LC1- D40 50 65
LR1-D 63359	48~57	15	25	30	30	45	LC1- D40 50 65
LR1-D 63361	57~66	18.5	30	37	37	55	LC1- D80 95
LR1-D 80363	63~80	22	33~37	33~37	33~37	59~63	LC1- D80 95

3UA

Thermal overload realy 热继电器系列

适用范围 Application

3UA 系列热继电器适用于交流50/60Hz, 额客电压660~1000V, 额定电流0.1~630A的电力系统中, 供三相交流异步电动机作过载和断相保护之用, 整定电流可以调节, 且大部分热元件的整定电流为交叉式重叠排列. 便于用户选用, 在-25度至55度的空气温度范围内具有温度补偿, 有断开常闭触头的试验按钮并具有动作指示, 自动脱扣指示, 产品符合IEC60947-4标准.

3UA series thermal overload realy is suitable for using in power system with AC 50/60Hz, rated operation voltage up to 660V and 1000V current from 0.1A to 630A it is used to protect AC three-phase asynchronous motor against overload and open-phase. the current setting value can be regulated and the setting current values of many thermai elem-ents are intercrossing overleppng arrange ment for easy selctrng by the customers from -25°C~55°C air temperature as the products have temperature compensating the relays have the test push button for breaking NC contacts the operating indication and free trip characteristics, the items conform to IEC60947-4



AMUR-3UA-50-52



AMUR-3UA-59



AMUR-3UA-62

技术参数 Specifications

型号 type	额定工作电流 rated oper ating current(A)	额定绝缘电压 rated insul ation voltage(V)	电流调整范围 current serring range(A)
3UA50	12.5	660	0.1~0.16, 0.16~0.25, 0.25~0.4, 0.32~0.63, 0.63~1.0, 0.8~1.25, 1.0~1.6, 1.25~2.0, 1.6~2.5, 2.0~3.2, 2.5~4.0, 3.2~5.0, 4.0~6.3, 5.0~8.0, 6.3~10.0, 8.0~12.5
3UA52	25	660	0.1~0.16, 0.16~0.25, 0.25~0.4, 0.4~0.63, 0.63~1.0, 0.8~1.25, 1.0~1.6, 1.25~2.0, 1.6~2.5, 2.0~3.2, 2.5~4.0, 3.2~5.0, 4.0~6.3, 5.0~8.0, 6.3~10.0, 8.0~12.5, 10.0~16.0, 12.5~20.0, 16.0~25.0
3UA54	32	660	4.0~6.3, 6.3~10.0, 10.0~16.0, 12.5~20.0, 16.0~25.0, 20.0~32.0, 25.0~36.0
3UA58	80	660	16.0~25.0, 20.0~32.0, 25.0~40.0, 32.0~50.0, 40.0~57.0, 50.0~63.0, 57.0~70.0, 63.0~80.0
3UA59	63	660	0.1~0.16, 0.16~0.25, 0.25~0.4, 0.4~0.63, 0.63~1.0, 0.8~1.25, 1.0~1.6, 1.25~2.0, 1.6~2.5, 2.0~3.2, 2.5~4.0, 3.2~5.0, 4.0~6.3, 5.0~8.0, 6.3~10.0, 8.0~12.5, 16.0~16.0, 12.5~20.0, 16.0~25.0, 20.0~32.0, 25.0~40.0, 32.0~45.0, 40.0~57.0, 50.0~63.0
3UA62	180	660	55.0~80.0, 63.0~90.0, 80.0~110.0, 90.0~120.0, 110.0~135.0, 120.0~150.0, 135.0~160.0, 150.0~180.0
3UA66	400	660	80.0~125.0, 125.0~200.0, 180.0~250.0, 200.0~320.0, 250.0~400.0
3UA68	630	660	320.0~500.0, 400.0~630.0

GTK

Thermal overload relay 热继电器系列

适用范围 Application

该系列热过载继电器主要用于交流50/60Hz，额定绝缘电压660V，额定电流0.1~85A的电路中，作为电动机过载和断相保护之用。

此继电器有不同的机构及温补偿，可插入CEC1-D系列，AC触头，该产品符合IEC60947-4标准。

This series of thermal overload relay can be used in the circuit of 50/60Hz, rated insulation voltage 660V, rated current 0.1~85A for protecting the phase break when the electric motor is overload, the relay has different mechanism and temperature compensation can be plugged in GMC series AC contactor the products comply with IEC60947-4



AMUR-GTK-22



AMUR-GTK-40



AMUR-GTK-85

技术参数 Specifications

型号 type	热元件 Thermal component	
	额定电流 Rated current(A)	额定电流选择范围 Regular or scale of rated current(A)
GTK-22	0.14	0.10~0.16
	0.21	0.16~0.25
	0.33	0.25~0.40
	0.52	0.40~0.63
	0.82	0.63~1.0
	1.3	1.0~1.6
	2.1	1.6~2.5
	3.3	2.5~4.0
	5	4.0~6.0
	6.5	5.0~8.0
GTK-40	7.5	6.0~9.0
	8.5	7.0~10.0
	11	9.0~13.0
	15	12.0~18.0
	19	16.0~22.0
	5	4.0~6.0
	6.5	5.0~8.0
	7.5	6.0~9.0
	8.5	7.0~10.0
	11	9.0~13.0
GTK-85	15	12.0~18.0
	19	16.0~22.0
	22	18.0~26.0
	30	24.0~36.0
	34	28.0~40.0
	8.5	7.0~10.0
	11	9.0~13.0
	15	12.0~18.0
	19	16.0~22.0
	22	18.0~26.0
30	24.0~36.0	
34	28.0~40.0	
42	34.0~50.0	
55	45.0~65.0	
65	54.0~75.0	
74	63.0~85.0	

LR2-F

Thermal overload relay 热继电器系列

适用范围 Application

LR2-F 系列继电器适用于交流50/60Hz,额定电流至630A,电压至690V的电路中,用于长时间连续不断地运行电动机的保护过载及分相,此继电器具有温度补偿,动作指示,手动及自动复位等功能。

LR2-F thermal overload relay is applicable to protect over load and open-phase of long time continuous or discontinuous working AC motor in the circuit of AC 50/60Hz,current up to 630A voltage up to 690V it has features of temperature compensation action indication manual and automatic restoration.

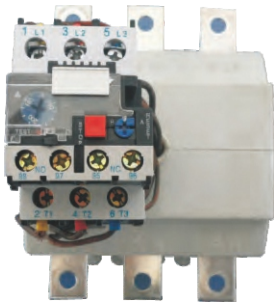

AMUR-LR2-F200

技术参数 Specifications

型号 type	额定工作电流 rated operating current(A)	额定工作电压 rated working voltage(V)	额定绝缘电压 Rated insulating voltage(UI)(V)	适用接触器 Suitable contactor
LR28-200	80-125	380	690	CEC1-Y115
	100-160	380	690	CEC1-Y150
	125-100	380	690	CEC1-Y185
LR28-630	160-250	380	690	CEC1-Y225
	200-315	380	690	CEC1-Y265
	250-400	380	690	CEC1-Y330/440
	315-500	380	690	CEC1-Y500
	400-630	380	690	CEC1-Y630

安装与外形尺寸图 Dimension & mounting size

LR28-200 独立系统
LR28-200 Independent style

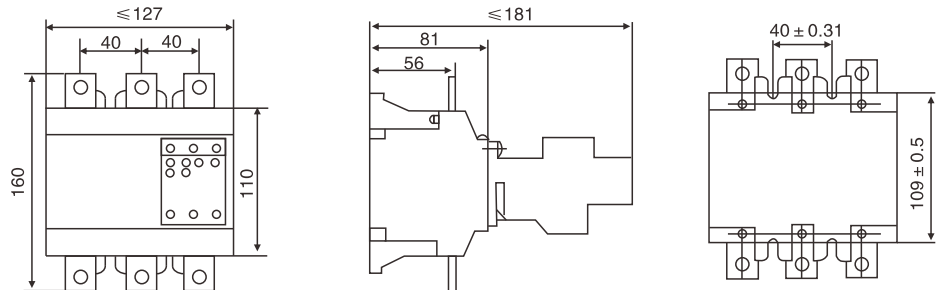

LR28-F630 独立系统
LR28-F630 Independent style

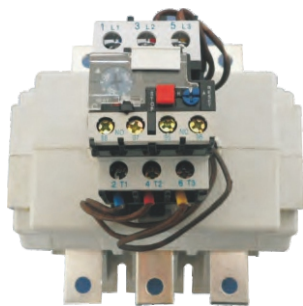
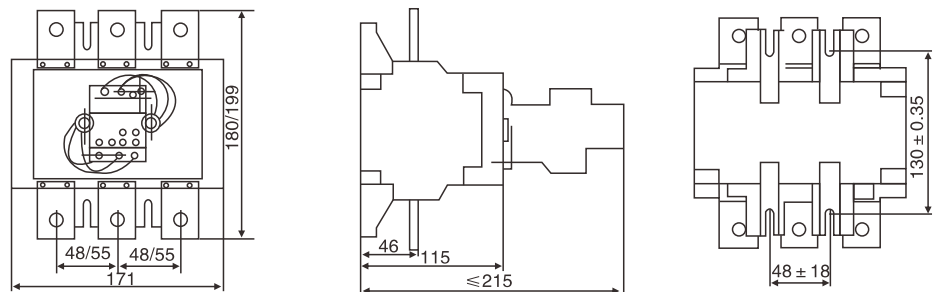

AMUR-LR2-F630

前为LR2-F400/630尺寸
后为LR2-F500/630, 630/630

*Before"/"is LR2-F400/630 size.
*After"/"is LR2-F500/630, 630/630size.

LE1-N Magnetic starter 起动器系列

适用范围 Application

LE-N 系列磁力起动器主要适用于交流50/60Hz,额定电压至550V的电路中, 供远距离接通与分断电路及频繁起动控制电动机之用, 此产品具有体积小、重量轻、功率损耗低、效率高、性能安全可靠等优点。

LE-N magnetic starter is mainly applied t circuit of AC50/60Hz,voltage up to 550V for far distance making and breaking circuit and frequently starting and controlling motor it has the features of small volume light weight low power consumption high efficiency safe and reliable performance etc.

技术参数 Specifications

Ac3最大功率 Maximum power AC3duty(kw)						额定电流 Rated Current (A)	防护等级 protection	型号 type		适用热继电器 Suitable thermal relay((A)
220V 230V	380V 400V	415V	440V	500V 550V	660V 690V			长寿命 LL (long life)	普通寿命 NL(3) normal flie	
2.2	4	4	4	5.5	5.5	9	IP42 IP65	LE1 -N094... LE1 -N093...		LR2 -D1312 LR2 -D1314
3	5.5	5.5	5.5	7.5	7.5	12	IP42 IP55	LE1 -N124... LE1 -N123...	LE1 -N094... LE1 -N093...	LR2 -D1316
4	7.5	9	9	10	10	18	IP42 IP55	LE1 -N188... LE1 -N185...	LE1 -N124... LE1 -N123...	LR2 -D1321
5.5	11	11	11	5	15	25	IP42 IP55	LE1 -N258... LE1 -N255...	LE1 -N188... LE1 -N185...	LR2 -D1322 LR2 -D2353
7.5	15	15	15	18.5	18.5	32	IP55	LE1 -N325...	LE1 -N255...	LR2 -D2355
11	18.5	22	22	22	30	40	IP55	LE1 -N405...	LE1 -N325...	LR2 -D3353 LR2 -D3355
15	22	25	30	30	33	50	IP55	LE1 -N505...	LE1 -N405...	LR2 -D3357 LR2 -D3359
18.5	30	37	37	37	37	65	IP55	LE1 -N655...	LE1 -N505...	LR2 -D3361
22	37	45	45	55	45	80	IP55	LE1 -N805...	LE1 -N655...	LR2 -D3363 LR2 -D3365
25	45	45	45	55	45	95	IP55	LE1 -N955...	LE1 -N805...	LR2 -D3365

附件 enclosure	LE1 -N09 and N12	双绝缘, 防护等级为IP42 Double insulated protected to Ip42 3 or to IP659(4)
	LE1 -N18 and N25	双绝缘, 防护等级为IP427 Double insulated protected to Ip427 3 or to IP557(4)
	LE1 -N32 N95	Metal IP55 to JR 559
Control 2 pushbuttons mounted on enclosure cover	LE1 -N09 N95	1 green Start button"I" 1 red Stop/Reset button"O"
连接 connections	LE1 -N09 N95	Pre-wired power and control circuit connections



AMUR-LE1-N09



AMUR-LE1-N18



AMUR-LE1-N32

标准控制断路器电压Standard control circuit voltages

电压 Volts	24	42	48	110	220/230	230	240	380/400	400	415	440
50/60Hz	B7	D7	E7	F7	M7	P7	U7	Q7	V7	N7	R7

LE1-D

magnetic starter 起动器系列



AMUR-LE1-D09



AMUR-LE1-D25



AMUR-LE1-D95

适用范围 Application

LE1-D 系列磁力起动器主要适用于交流50/60Hz, 额定电压550V的电路中, 供远距离接通与分断电路及频繁起动, 控制电动机之用, 此产品具有体积小, 重量轻, 功率损耗低, 效率高、性能安全可靠等特点。

LE1-D magnetic starter is mainly applied to circuit of ac 50/60Hz voltage up to 550V for far distance making and breaking circuit and frequently starting and controlling motor it has the features of small volume light weight low power consumption high efficiency safe and reliable performance etc

技术参数 Specifications

Ac3最大功率 Maximum power Ac3 duty(KW)						额定电流 Rated current (A)	防护等级 Protection	型号Code number		适用热继电器 Suitable thermal relay(A)
220V 230V	380V 400V	415V	440V	500V	660V 690V			长寿命 LL(Long life)	普通寿命 NL(3) normal life	
2.2	4	4	4	5.5	5.5	9	IP42	LE1 -D094...		LR2 -D1312
							IP65	LE1 -D093...		LR2 -D1314
3	5.5	5.5	5.5	7.5	7.5	12	IP42	LE1 -D124...	LE1 -D094...	LR2 -D1316
							IP55	LE1 -D123...	LE1 -D093...	
4	7.5	9	9	10	10	18	IP42	LE1 -D188...	LE1 -D124...	LR2 -D1321
							IP55	LE1 -D185...	LE1 -D123...	
5.5	11	11	11	5	15	25	IP42	LE1 -D258...	LE1 -D188...	LR2 -D1322
							IP55	LE1 -D255...	LE1 -D185...	LR2 -D2353
7.5	15	15	15	18.5	18.5	32	IP55	LE1 -D325...	LE1 -D255...	LR2 -D2355
11	18.5	22	22	22	30	40	IP55	LE1 -D405...	LE1 -D325...	LR2 -D3353
										LR2 -D3355
15	22	25	30	30	33	50	IP55	LE1 -D505...	LE1 -D405...	LR2 -D3357
										LR2 -D3359
18.5	30	37	37	37	37	65	IP55	LE1 -D655...	LE1 -D505...	LR2 -D3361
22	37	45	45	55	45	80	IP55	LE1 -D805...	LE1 -D655...	LR2 -D3363
										LR2 -D3365
25	45	45	45	55	45	95	IP55	LE1 -D955...	LE1 -D805...	LR2 -D3365

标准控制回路电压Standard control circuit voltages

电压 Volts	24	42	48	110	220/230	230	240	380/400	400	415	440
50/60Hz	B7	D7	E7	F7	M7	P7	U7	Q7	V7	N7	R7

安装与外形尺寸图Dimension & mounting size

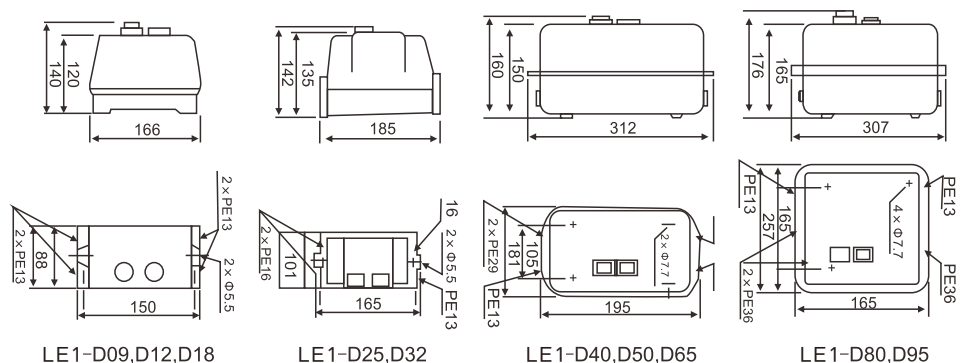



(+86) 17300995175



www.vekon.global



info@vekon.global



No. 99, Binhainan Third Road, Yueqing Economic
Development Zone, Zhejiang Province, China